



ALCAD

AMPLIFICADORES MULTIBANDA CONFIGURABLES
CONFIGURABLE MULTIBAND AMPLIFIERS
AMPLIFICATEURS MULTIBANDES CONFIGURABLES



SERIE 904 SERIES

CODIGO-CODE-CODE		9040035					9040006				
MODELO-MODEL-MODELE		CF-513					CA-510				
Número de entradas Number of inputs Nombre d'entrées		5					5				
Rango de frecuencia Frequency range Gamme de frequences	Band	BI/FM	BIII/DAB	UHF1	UHF2	UHF3	BI/FM	BIII/DAB	UHF1	UHF2	UHF3
	MHz	47-108	160-260	470 - 862 ⁽¹⁾			47-108	160-260	470 - 862 ⁽¹⁾		
Ganancia Gain Gain	dB	40 ± 1,0		45 ± 2,0			30 ± 1,0		33 ± 2,0		
Margen de equalización Adjustable equalization range Plage de réglage de pente	dB	20									
Test de salida Output test point Sortie test	dB	30 ± 0,5									
Nivel de salida Output level Niveau de sortie	dB	115 DIN 45004B 112 (IMD ₃ -60 dB) 105 (IMD ₂ -60 dB) 105 (CTB -60 dB) 105 (CSO -60 dB) 104 (XMOD -60 dB)									
Figura de ruido Noise figure Facteur de bruit	dB	8 ± 1,0		10 ± 1,0			8 ± 1,0		10 ± 1,0		
Tensión de salida Output voltage Tension de sortie	V ₋₋₋	24					12				
	mA	60					60				
Pérdidas de retorno Return loss Pertes de retour	dB	≥ 10									

DIN 45004B: 3 unequal carriers, IMD₃ at 60 dB

IMD₃ -60 dB: 2 equal carriers, EN 50083-3

IMD₂ -60 dB: 2 equal carriers, EN 50083-3

CTB -60 dB: 42 equal carriers, EN 50083-3

CSO -60 dB: 42 equal carriers, EN 50083-3

XMOD -60 dB: 42 equal carriers, EN 50083-3

(1) Las entradas UHF1, UHF2 y UHF3 son configurables mediante filtros de paso y rechazo.

(1) The UHF1, UHF2 and UHF3 inputs are configured by means of rejection and pass filters.

(1) Les entrées UHF1, UHF2 et UHF3 sont configurables par les filtres de rejet et passe-bandes.

CÓDIGO-CODE-CODE		9040035	9040006
MODELO-MODEL-MODELE		CF-513	CA-510
Fusible	V~	250	
Fuse	A	1,6 (Type F)	
Fusible			
Tensión de red	V~	230 ±15% 50/60 Hz	
Mains voltage	VA	25	
Tension du secteur			
Temperatura en proximidad del equipo	°C	-10 ... +65	
Operating temperature close to equipment			
Température en proximité de l'équipement			
Temperatura ambiente con/sin ventilador	°C	-10 ... +55/+45	
Room temperature with/without fan			
Température ambiante avec ou sans ventilateur			
Índice de protección		IP 50D	
Protection index			
Indice de protection			

AMPLIFICADOR CA-510

AMPLIFIER CA-510

AMPLIFICATEUR CA-510

Indicador de funcionamiento
Indicator of operation
Voyant de fonctionnement

Fusible
Fuse
Fusible

Regulador de ganancia
Gain regulator
Réglage de gain

Salida
Output
Sortie

Test de salida (-30dB)
Output test point (-30dB)
Sortie test (-30dB)

Conexión de tierra
Grounding
Prise de terre

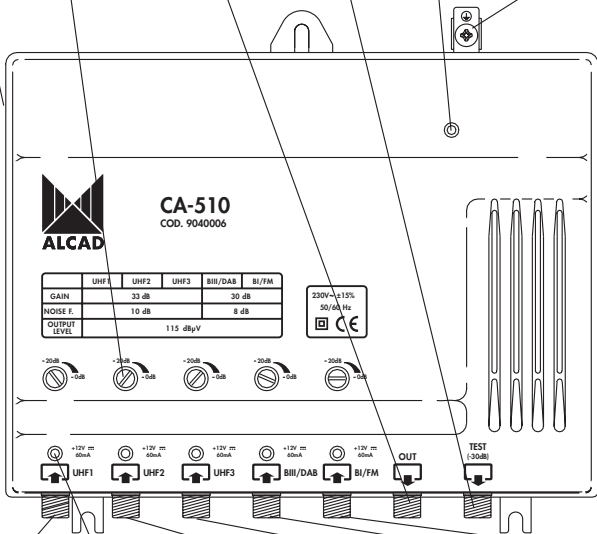

CA-510
COD. 9040006

	UHF1	UHF2	UHF3	BIII/DAB	BI/FM
GAIN		33 dB			30 dB
NOISE F.		10 dB			8 dB
OUTPUT LEVEL	115 dB μ V				

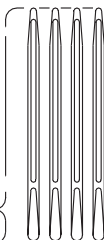

Entrada UHF1
UH1 input
Entrée UHF1

Entrada UHF2
UH2 input
Entrée UHF2

Entrada UHF2
UH2 input
Entrée UHF2

Entrada BIII/DAB
BIII/DAB input
Entrée BIII/DAB

Entrada BI/FM
BI/FM input
Entrée BI/FM

Indicador de alimentación de preamplificadores
Preamplifier supply indicator
Voyants de passage d'alimentation des preamplificateurs

REDUCCIÓN DEL NIVEL DE SALIDA
REDUCTION OF THE OUTPUT LEVEL
REDUCTION DU NIVEAU DE SORTIE

Canales Channels Canaux	NIVEL DE SALIDA / OUTPUT LEVEL / NIVEAU DE SORTIE											
		2	3	4	5	6	7	8	9	10	11	12
Nivel máximo Maximum level Niveau maximum	dB μ V	115	113	111	110	110	109	109	108	108	107	107

DIN 45004B

CÓMO ALIMENTAR EL AMPLIFICADOR
HOW TO FEED THE AMPLIFIER
COMMENT ALIMENTER L'AMPLIFICATEUR

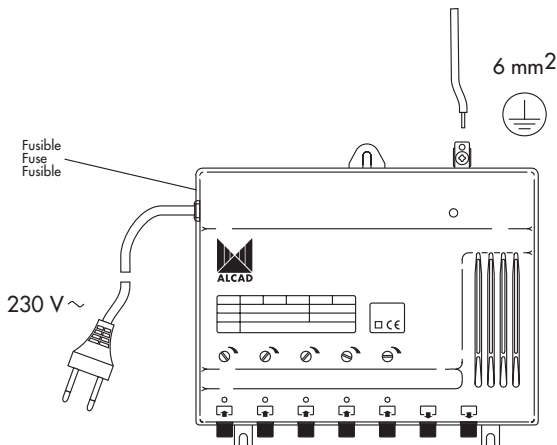

SUSTITUCIÓN DEL FUSIBLE
FUSE REPLACEMENT
REPLACEMENT DU FUSIBLE

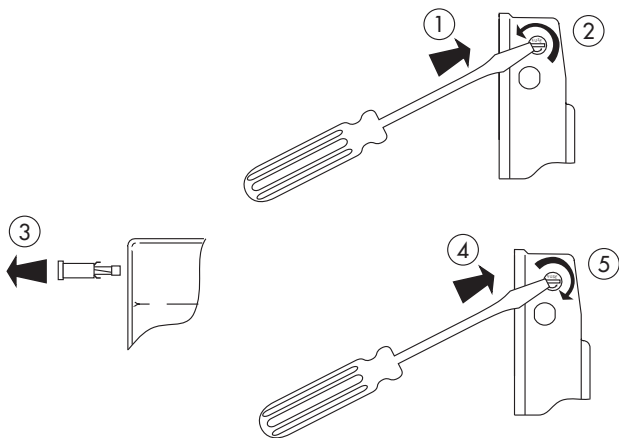

CÓMO AJUSTAR LAS ENTRADAS
ADJUSTMENT OF THE INPUTS
REGLAGE DES ENTREES

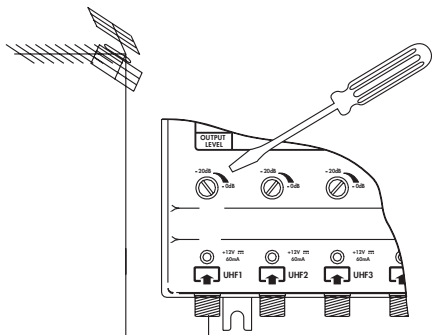

TENSIÓN DE SALIDA SIN CARGA (CA-510)
OUTPUT VOLTAGE WITHOUT LOAD (CA-510)
TENSION DE SORTIE SANS CHARGE (CA-510)

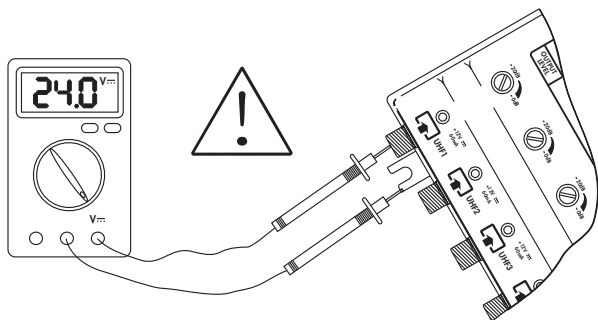

CÓMO ALIMENTAR PREAMPLIFICADORES
HOW TO FEED PREAMPLIFIERS
COMMENT ALIMENTER DES PREAMPLIFICATEURS

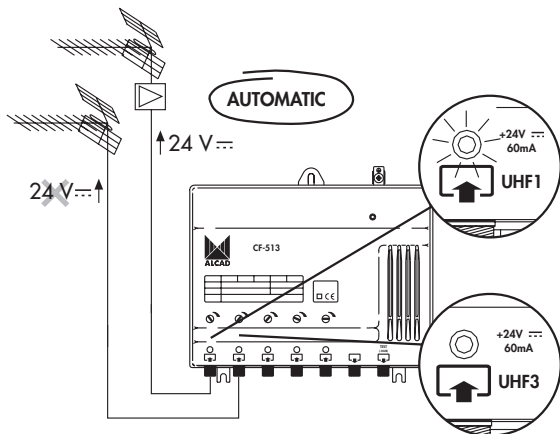

FILTROS DISPONIBLES PARA CADA ENTRADA UHF
 FILTERS AVAILABE FOR EACH UHF INPUT
 FILTRES DISPONIBLES POUR CHAQUE ENTRÉES UHF

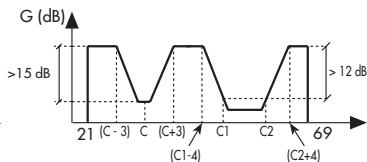
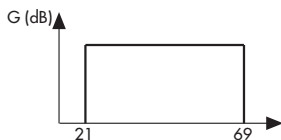
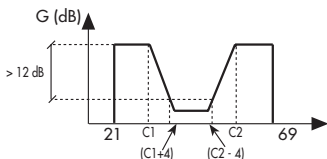
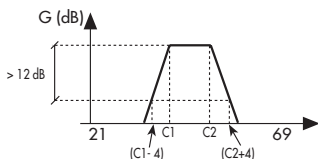
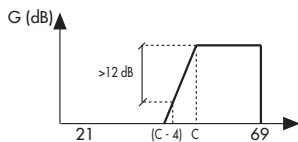
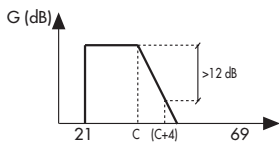
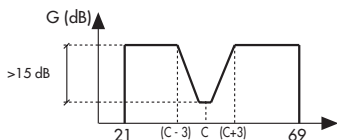
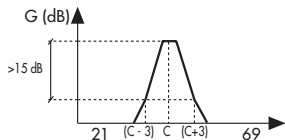

La configuración de los filtros se realiza en fábrica, bajo pedido.
 The configuration of the filters is prepared in the factory upon request.
 La configuration des filtres est réalisée sur commande, en usine.

ESQUEMAS TÍPICOS
 CONNECTION DIAGRAMS
 SCHEMAS DE CONNEXION

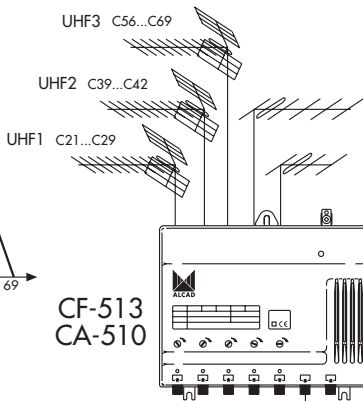
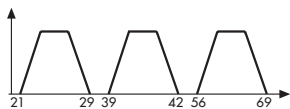

3

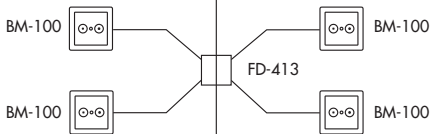

2

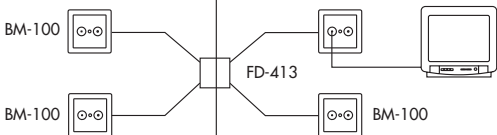

1

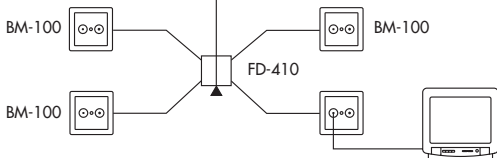



DECLARATION OF CONFORMITY

according to EN ISO/IEC 17050-1:2004

Manufacturer's Name: ALCAD, S.A.
Manufacturer's Address: Pol. Ind. Arreche-Ugalde, 1
Apdo. 455
20305 IRUN (Guipúzcoa)
SPAIN

declares that the product

Product Name: 904 Series: AMPLIFIERS

Model Number(s): CA-510, CF-513

Product Option(s): INCLUDING ALL OPTIONS

is in conformity with:

Safety: EN 50083-1:1993

EMC: EN 50083-2:2001

EN 61000-6-1:2001

EN 61000-4-2:1995 ESD 15KV AD, 8KV CD.

EN 61000-4-4:1995 EFT 4KV-2,5KHz Sig. Lines, 4KV-2,5KHz Power Lines.

EN 61000-4-5:1995 CWG 1KV Power Lines.

EN 61000-4-11:1994 Dips and Variation.

Technical Features : EN50083-3:2002
EN50083-5:2001

Supplementary Information:

The product herewith complies with the requirements of the Low Voltage Directive 73/23/ECC and the EMC Directive 89/336/EEC and their relevant amendments, gathered under the directive 93/68/EEC.

Note: to comply with these directives, do not use the products without covers and operate the system as specified.



Irún,

06-09-06

Date

Anton Galarza / General Manager

Especificaciones sujetas a modificación sin previo aviso
Specifications subject to modifications without prior notice
Les spécifications sont soumises à de possible modifications sans avis préalable



ALCAD, S.A.
Tel. 943 63 96 60
Fax 943 63 92 66
Int. Tel. +34 - 943 63 96 60
info@alcad.net
Apdo. 455 - Pol. Ind. Arreche-Ugalde, 1
20305 IRUN - Spain

www.alcad.net

FRANCE - Hendaye
Tel. 00 34 - 943 63 96 60

GERMANY - Munich
Tel. 089 55 26 480

CZECH REPUBLIC - Ostroavice
Tel. 546 427 059

UNITED ARAB EMIRATES - Dubai
Tel. 971 4 887 19 50

POLAND - Cieszyn
Tel. 48 33 851 06 35



ISO 9001

